

ASSEMBLY INSTRUCTION 400L S AND 500L S GRAVITY LOCK

The system is to keep the cover closed against bad use, but to ensure an opening of the container at the same time by the user by means of keys.

The version gravity lock consists of two parts, one assembled on the lid; engage in to the attachment on the body. Through the gravity function automatically the lid opens if the bin is over 80° turned and closed under 80°.



1. PART NUMBERS

Article	Numbers	View
Gravity lock body part	1	 <p style="text-align: center;">Franzen Sudhaus</p>
Gravity lock lower lid part	1	 <p style="text-align: center;">Franzen Sudhaus</p>
Gravity lock lid upper part	1	 <p style="text-align: center;">Franzen Sudhaus</p>
Base plate f. gravity lock art. n° 152477	1	
MGB 400_500L S reinforcement f. SKS art. n°.405503	1	
Rivet 5 x 14 K11 art. n° 20394	4	

2. ASSEMBLY CONTAINER BODY PARTS

The drillings are set, from frontal inside of the bin according with the drilling picture. The hole diameter must be 10mm.

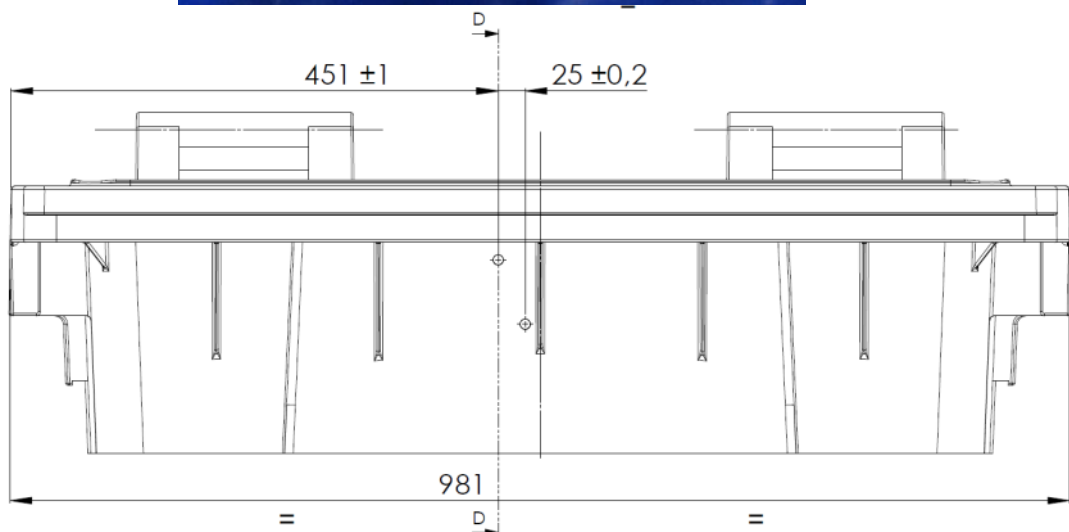

Afterwards the bush parts are positioned from outside in the 2 holes.

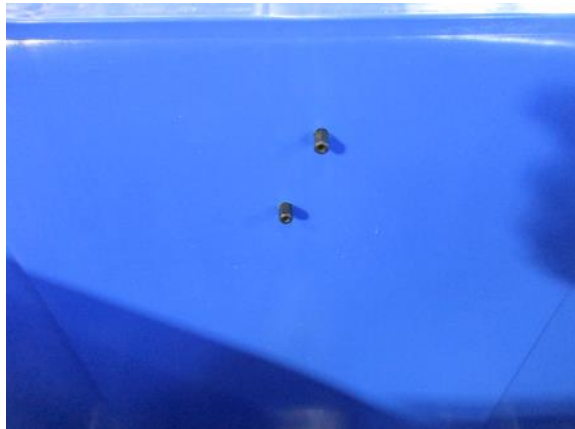

2. ASSEMBLY

It follows the assembling of the lock parts with 2 PT screws. (on photo Franzen)



The lid top part (red cap) be fastened with the lid lower part through two PT screws, between them the metal plate. (on photo Sudhaus)



Additional the reinforcement bow will adjusted inside the



3. ASSEMBLY CONTAINER LID PARTS

At first the drilling for the big lock hole (diamter 20mm) set in the front of the lid according with the drawing. Drawing shows Franzen 17mm from the middle, for Sudhaus 26mm necessary.

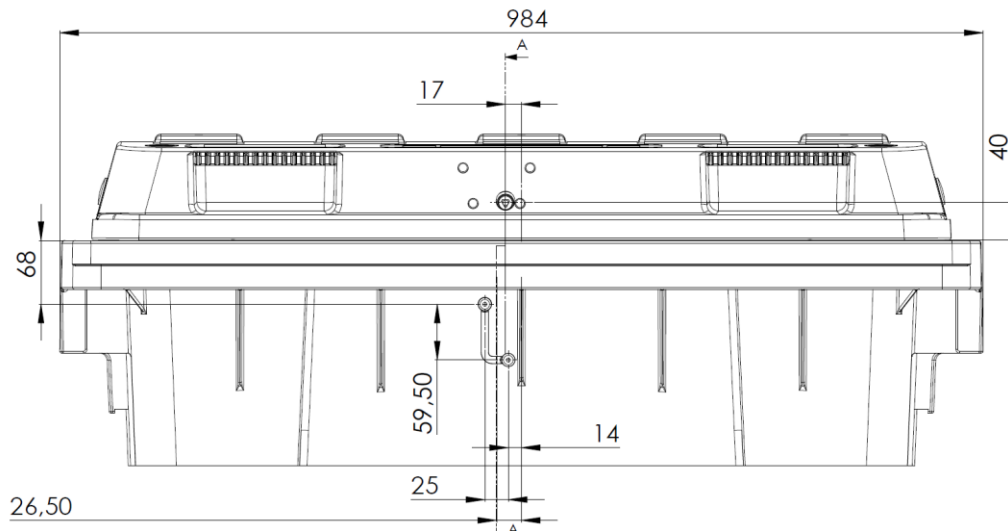

Then the fastening holes are set in the front of the lid with diameter 5.2mm according the drawing.

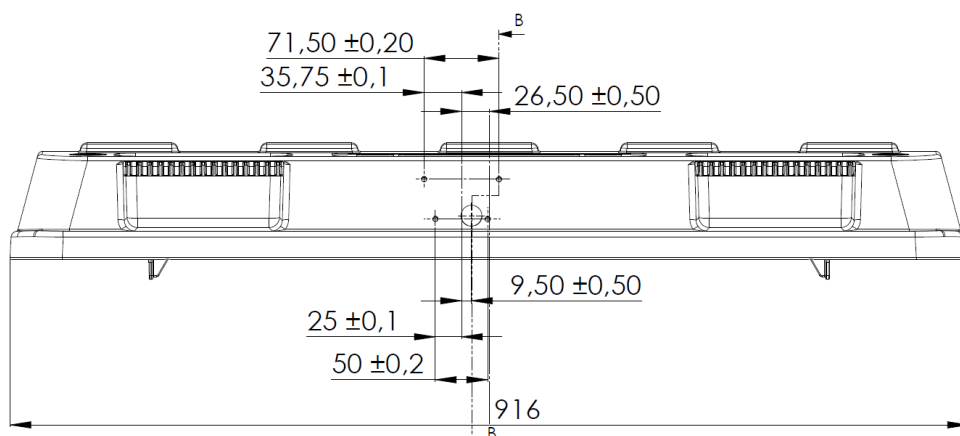

3. ASSEMBLY CONTAINER LID PARTS

Afterwards the lid assembling part be positioned from inside. (on photo Franzen)



With 2x 5mm rivets from outside the completed lid part of the gravity lock be fastened on the lid.



Then the lid part will fastened with a additional reinforcement also with 2 rivets 5mm from outside.



To finish the assembly the functional check is necessary.

4. CONTACT

ESE GmbH
Department PD&M
Eisenstr. 2
57482 Wenden-Gerlingen
16816 Neuruppin
Germany

www.ese.com/de/kontakt